

Nano Bracket



NanoBracket – holder for NanoStation

NanoBracket is a holder for popular Wireless CPE NanoStation from Ubiquity Networks. NanoBracket holder enables installation of both versions (old and new) of NanoStation on wall or mast. It is possible to set NS5 and NS2 to any direction in 90° range by using Nano Bracket. Disposal of movement is provided by ball hinge. Installation of NanoBracket holder is very simple and fast although the holder is made with the emphasis on assurance of maximum security of device. The device is compact and stable after the mounting.

www.nanobacket.info

Installation of NanoBracket's body to NanoStation

- In the first step, insert ball hinge into the hole of the holder NanoBracket.
- Put one half of NanoBracket's body between holds that are placed on NanoStation
- Put flat end of the part "ball" to free space between the body of NS and body of NB
- Cover it all by the 2. half of NanoBracket's body in order to assure fixed connection of NanoStation's and NanoBracket's bodies.
- Both parts secure by using screws.

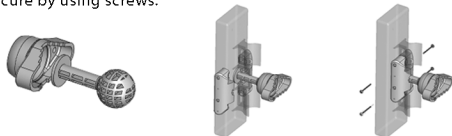

Installation of NanoBracket on Wall

- First, put screws M6 to holes in the part of NanoBracket called "bearing (base) for ball".
- Put wall plugs to the wall and screw bearing (base) for ball tight to wall by using screws.
- Consequently, put NanoStation with mounted NanoBracket on it on screws.
- The whole entity pulls by using nut under which we put saddles. In the meantime screw nut only temporary in order to be able to set NanoStation in requested direction.
- When NanoStation is set you can pull nuts to the end. Now, installation of NanoStation on wall by using mounting kit NanoBracket is completed.

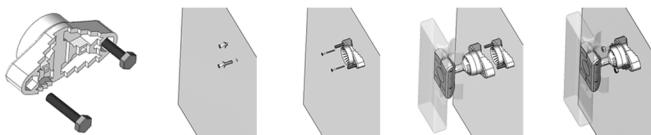

Installation of NanoBracket on Console or Mast

- At the beginning, put U-bolt on mast or console and insert the part of NanoBracket called "bearing (base) for ball" into it.
- Consequently, put NanoStation with mounted body of NanoBracket on U-bolt.
- The whole entity pulls by using nut under which we put saddles. In the meantime screw nut only temporary in order to be able to set NanoStation in requested direction.
- When NanoStation is set you can pull nuts to the end. Now, installation of NanoStation on mast or console by using mounting kit NanoBracket is completed.

